

Low Water and Level Controls — McDonnell & Miller

Series TC-4
Test-N-Check® Valves



- For hot water boilers
- Simplifies ASME CSD-1a. code mandated testing of low water cut-offs by eliminating the need to drain the boiler
- Includes one upper and one lower valve for mounting at crosses in equalizing lines
- Restricts water flow from the float chamber when the low water cut-off's blow down valve is open
- Adjustable built-in vacuum breaker in upper valve provides rapid evacuation of water from the float chamber
- 1" (25mm) NPT
- Maximum temperature 250°F (121°C)
- Maximum pressure 160 psi (11 kg/cm²)



Series TC-4
Upper Valve

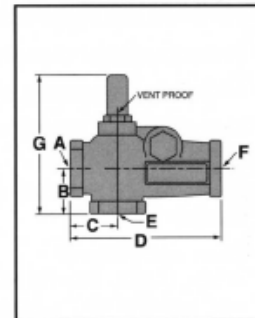

Series TC-4
Lower Valve

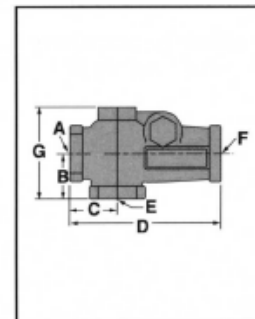

Series FS4-3
General Purpose Liquid Flow Switches



- Universal design serves the widest variety of applications
- For starting or stopping electrically operated equipment such as signal lights, alarms, motors, automatic burners, metering devices and others
- Replacement for Johnson Controls flow switch Model F61KB-11
- 1" (25mm) NPT
- Two electrical knock-outs allows connection from either end
- Sensitivity adjusting screw makes flow adjustment easy
- Single pole, double throw snap switch
- Hardened stainless steel bearings minimize friction
- Sealed Monel bellows
- Four Monel paddles included. Fits 1", 2" & 3" (25, 50 & 80mm) NPT, or the extended paddle can be trimmed to fit other pipe sizes



Series FS4-3

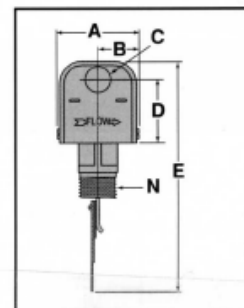

For prices on products or parts call us at 623-847-4788 or FAX 623-847-2386

Low Water and Level Controls — McDonnell & Miller

Series PCH & PCL  
General Purpose Liquid Level Controls

- For sophisticated multi-level control in tanks, boilers and hydronic systems
- Electronic circuitry with remote conductance probe level sensing:
 - Series PCH has a probe sensitivity of 4,000 ohms at 120 VAC for boiler water and most common liquid
 - Series PCL has a probe sensitivity of 60,000 ohms at 28 VAC for commercial distilled water and solutions
- LED low water indicator light
- No lock out with loss of power (if probe is in water)
- Teflon® coated probe ends provide protection from false signals [available on 24-72" (5.1 - 183cm) probes]
- No blow down required
- Current limiting device provided

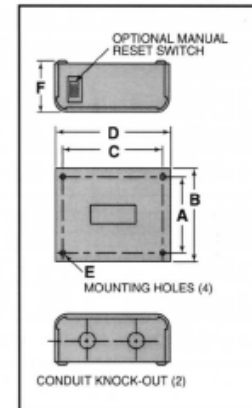

**Float Actuated
For Fuel Oil**

Series 80  
Liquid Level Controls

- For industrial or commercial applications where measuring or regulating Grade 2 fuel oil levels (with a gravity of 0.85 or greater) in storage tanks is required
- External mounting (with equalizing piping)
- ½" (15) NPT tappings provided at top, bottom, and sides of body
- Single pole, double throw switch
- Maximum operating pressure 5 psi (.35 kg/cm²)
- Maximum water temperature 190°F (87°C)

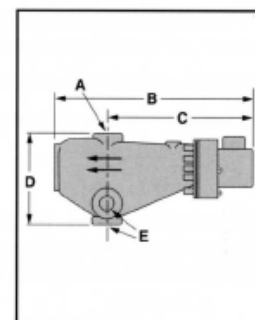

For prices on products or parts call us at 623-847-4788 or FAX 623-847-2386