

Low Water and Level Controls — McDonnell & Miller

Low Water Cut-Offs Combination Low Water Cut-Off/Pump Controllers for Steam Boilers

Series 193



Low Water Cut-Off/Pump Controllers

- For residential, commercial, and industrial high pressure steam boilers with a separate water column
- Maintains consistent water level regardless of pressure
- Water column with integral tapplings for gauge glass and tri-cock installations
- For boilers of any steaming capacity
- Switch isolated from steam cavity
- No. 5 Switch included
- Magnetic repulsion eliminates need for bellows
- Optional features
 - Manual reset
 - On/Off or proportional control switch to maintain constant boiler output
- 1" (25mm) NPT connections
- Maximum pressure 150 psi (10.5 kg/cm²)

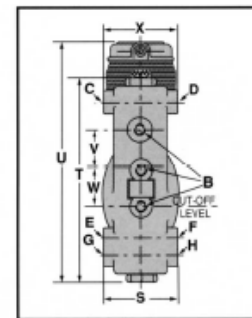
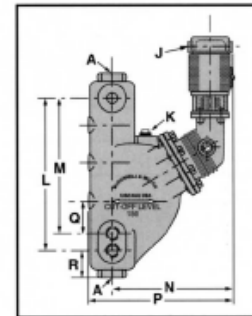

Water Feeders – Mechanical

Series 47



Mechanical Water Feeders

- For steam and hot water boilers with cold water feed
- Continuous maintenance of **minimum safe water level**, independent of electrical service
- Can be used with mechanical or electronic low water cut-off
- Direct action feeder mechanism

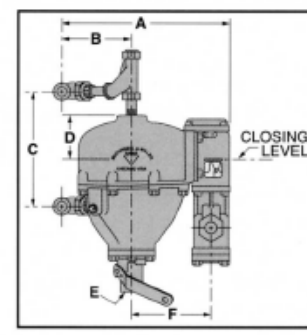

For prices on products or parts call us at 623-847-4788 or FAX 623-847-2386

Low Water and Level Controls — McDonnell & Miller

Series 247  
Mechanical Water Feeders

- For steam and hot water boilers with cold water feed
- Continuous maintenance of **minimum safe water level**, independent of electrical service
- Direct action feeder mechanism
- Quick-change replaceable cartridge valve and strainer
- Quiet, durable operation
- Isolated feed valve minimizes lime and scale build-up
- Optional features
 - No. 2 switch
 - Manual reset
- Model 247 can be field upgraded with a No. 2 switch to add low water cut-off function
- Maximum water supply pressure 150 psi (10.5 kg/cm²)
- Maximum pressure 30 psi (2.1 kg/cm²)

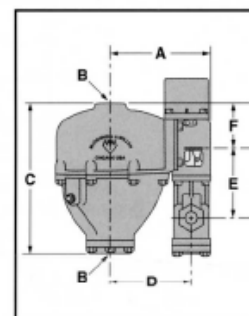
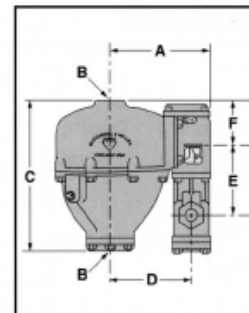

Series 51  
Mechanical Water Feeders

- For low pressure steam and hot water boilers larger than 5,000 sq. ft. (465m²) capacity with cold water feed
- Quick-change replaceable cartridge valve and strainer
- Optional features
 - No. 2 switch
 - Manual reset
 - Float block
- Integral strainer
- Maximum water supply pressure 150 psi (10.5 kg/cm²)
- Maximum pressure 35 psi (2.5 kg/cm²)

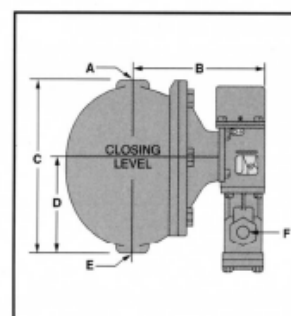
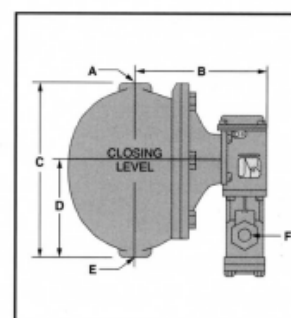

For prices on products or parts call us at 623-847-4788 or FAX 623-847-2386