

Low Water and Level Controls — McDonnell & Miller

Low Water Cut-Offs – Float Type For Hot Water Boilers

Series 63 Low Water Cut-Offs



- For residential, commercial, and industrial applications
- For boilers of any steaming capacity
- Heavy duty
- Test opening provided
- Optional manual reset available
- Maximum boiler pressure 50 psi (3.5 kg/cm²)

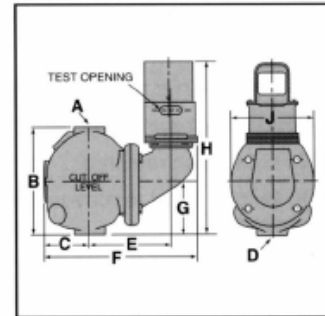

Low Water Cut-Offs – Float Type For Hot Water Boilers

Series 64 Low Water Cut-Offs



- For residential, commercial, and industrial boiler applications of any steaming capacity
- Heavy Duty
- Adjustable BX outlet for easy installation
- Dual precision switches for dependable operation of the low water cut-off and alarm or electric water feeder
- Packless bellows
- Optional manual reset available
- 1" (25mm) NPT equalizing pipes required
- Maximum boiler pressure 50 psi (3.5 kg/cm²)

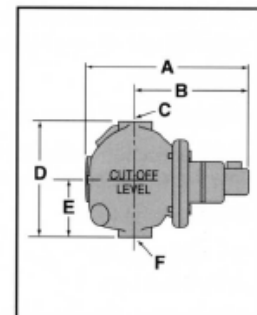

Model 64-A Low Water Cut-Offs



- Quick hook-up fittings provided for installation directly into gauge glass tapings
- For low pressure boilers 15 psi (1 kg/cm²) maximum

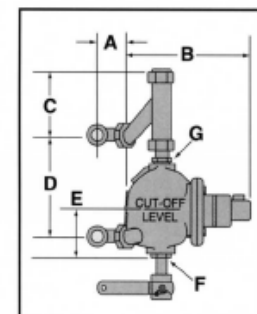

For prices on products or parts call us at 623-847-4788 or FAX 623-847-2386

Low Water and Level Controls — McDonnell & Miller

**Low Water Cut-Offs – Float Type
For Hot Water Boilers (continued)**

Series 764
Low Water Cut-Offs



- For residential, commercial, and industrial boiler applications of any steaming capacity
- Heavy duty
- Adjustable BX outlet for easy installation
- Dual precision switches for dependable operation of the low water cut-off and alarm or electric water feeder
- Packless bellows
- 2½" (65mm) NPT side tapping provided for installation with close nipple
- Maximum boiler pressure 50 psi (3.5 kg/cm²)

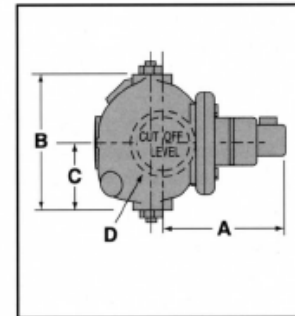

**Low Water Cut-Offs – Probe Type
For Hot Water Boilers (continued)**

Series PS-850
Low Water Cut-Offs



- For residential, commercial, and industrial applications
- Electronic operation
- LED low water indicator light
- Test switch and LED indicator light
- Optional manual reset switch available
- No lock out with loss of power (if probe is in water)
- No blow down required
- No moving parts
- Maximum ambient temperature 120°F (49°C)
- Voltage across probe to ground 14 VAC
- Probe sensitivity 3,000 ohms at 120 or 24 VAC supply
- Power consumption 3 VA
- Meets ANSI specification Z21.13a – Model PS-852
- Maximum water temperature 250°F (121°C)
- Maximum water pressure 160 psi (11.2 kg/cm²)

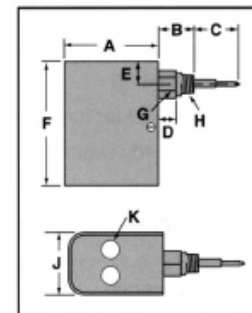

For prices on products or parts call us at 623-847-4788 or FAX 623-847-2386

Low Water and Level Controls — McDonnell & Miller

Low Water Cut-Offs – Probe Type For Steam Boilers

Series PS-800 Low Water Cut-Offs



- For residential and commercial applications
- Electronic operation
- Delay on Make (DOM) feature
- Delay on Break (DOB) feature
- LED low water indicator light
- Test switch and LED indicator light
- Optional manual reset switch available
- Optional remote sensor available – Model PS-801-RX2
- Meets ANSI specification Z21.13a – Model PS-802
- No lock out with loss of power (if probe is in water)
- No blow down required
- No moving parts
- Maximum ambient temperature 120°F (49°C)
- Voltage across probe to ground 14 VAC
- Probe sensitivity 3,000 ohms at 120 or 24 VAC supply
- Power consumption 3 VA
- Maximum water temperature 250°F (121°C)
- Maximum steam pressure 15 psi (1 kg/cm²)

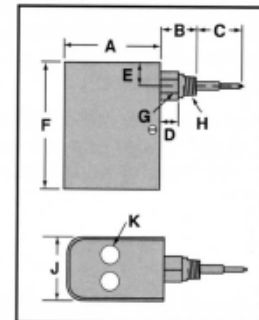

Low Water Cut-Offs – Probe Type For Hot Water Boilers

Series 900 Low Water Cut-Offs



- For residential, commercial, and industrial applications
- Electronic operation
- Available with automatic or manual reset
- Optional test switch and lamp indicator light available
- No blow down required
- 30 second delay to prevent nuisance tripping – Model 902-M
- Maximum ambient temperature 120°F (49°C)
- Voltage across probe to ground 125 VAC
- Probe sensitivity 6,000 ohms at 120 or 24 VAC supply
- Maximum power consumption 15 VAC
- Maximum water temperature 250°F (121°C)
- Maximum water pressure 160 psi (11.2 kg/cm²)

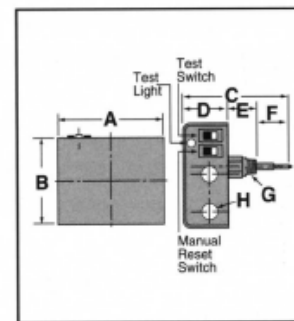
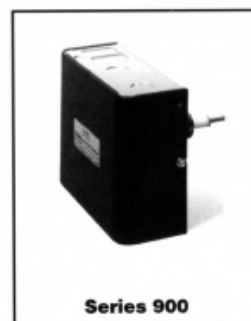

For prices on products or parts call us at 623-847-4788 or FAX 623-847-2386